

thyssenkrupp Polysius

Crushing Technologies

Unlock full crushing potential with thyssenkrupp Polysius technology.



thyssenkrupp

thyssenkrupp Industrial Solutions AG
Business Unit Polysius
Graf-Galen-Straße 17
59269 Beckum, Germany
P: +49 2525 990
www.thyssenkrupp-polysius.com

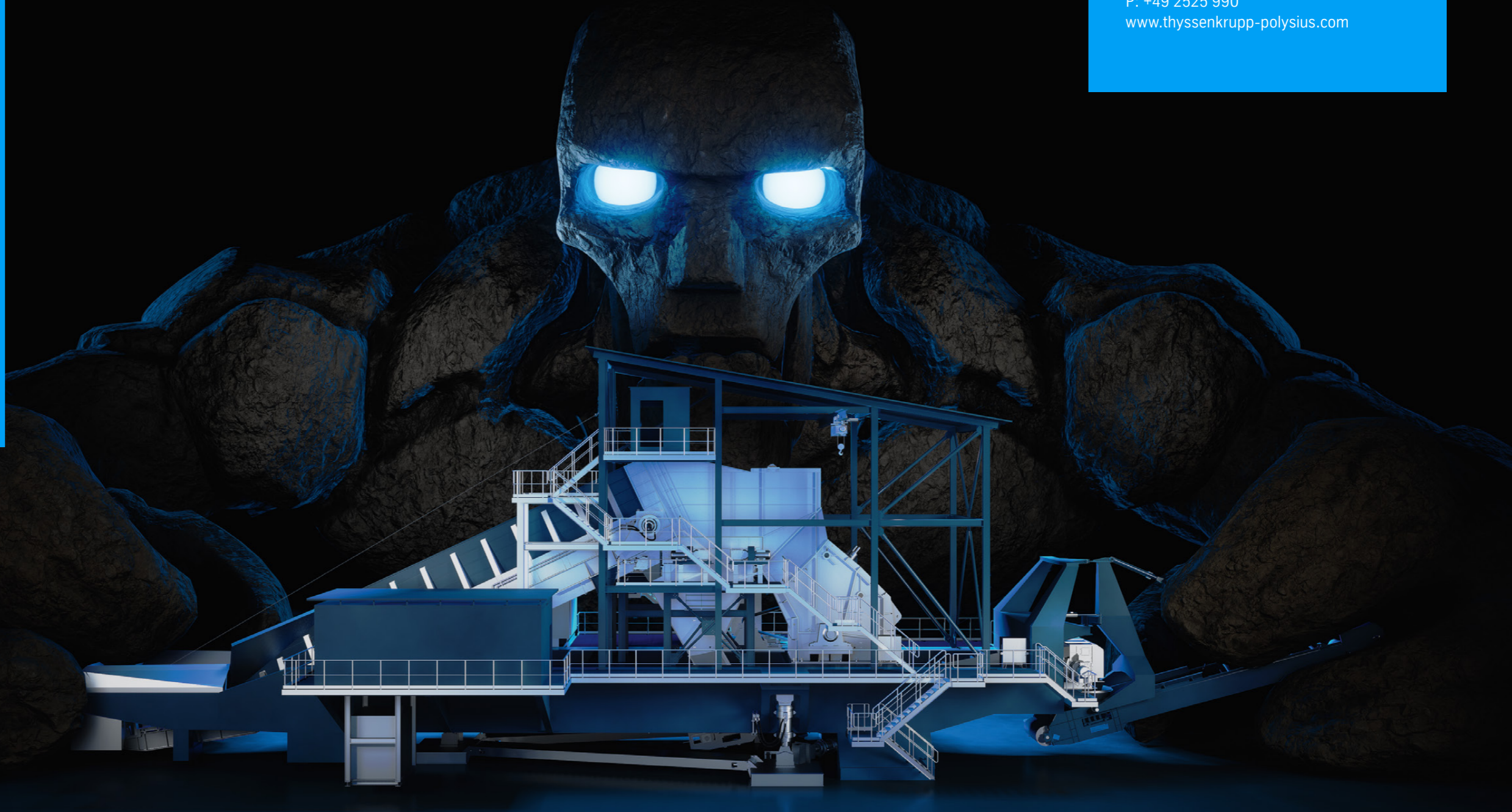

ENVISIONED TO SUCCEED

BUILT TO LAST

engineering.tomorrow.together.

Unlock full crushing potential

The challenges in the construction and maintenance of modern industrial plants and in the production of cement are many and great. Companies must react flexibly to changing requirements, take environmental influences into account, and at the same time deliver products of increasingly reliable quality – worldwide. Modern comminution technology must fulfil all of these requirements and also make an active contribution to the economic efficiency of production. Maximum utilization of the crushing machines with simultaneous high efficiency is therefore mandatory.

The crushers from thyssenkrupp Polysius meet these requirements. The portfolio, including titan® hammer crusher, impact crusher, double roller crusher, rollsizer and jaw crusher, ranges from stationary to semi-mobile and mobile crushing plants. With this broad product range, thyssenkrupp Polysius has the right solution for each individual application and requirement. Furthermore, with our service team, we offer an excellent maintenance and repair service for every crushing technology on the market – not just our own.

Contents

- 03 thyssenkrupp Polysius & crushing technologies
 - 04 Mobile crushers
 - 05 Semi-mobile crushers
 - 06 Stationary crushers
 - 07 Our view of service
-

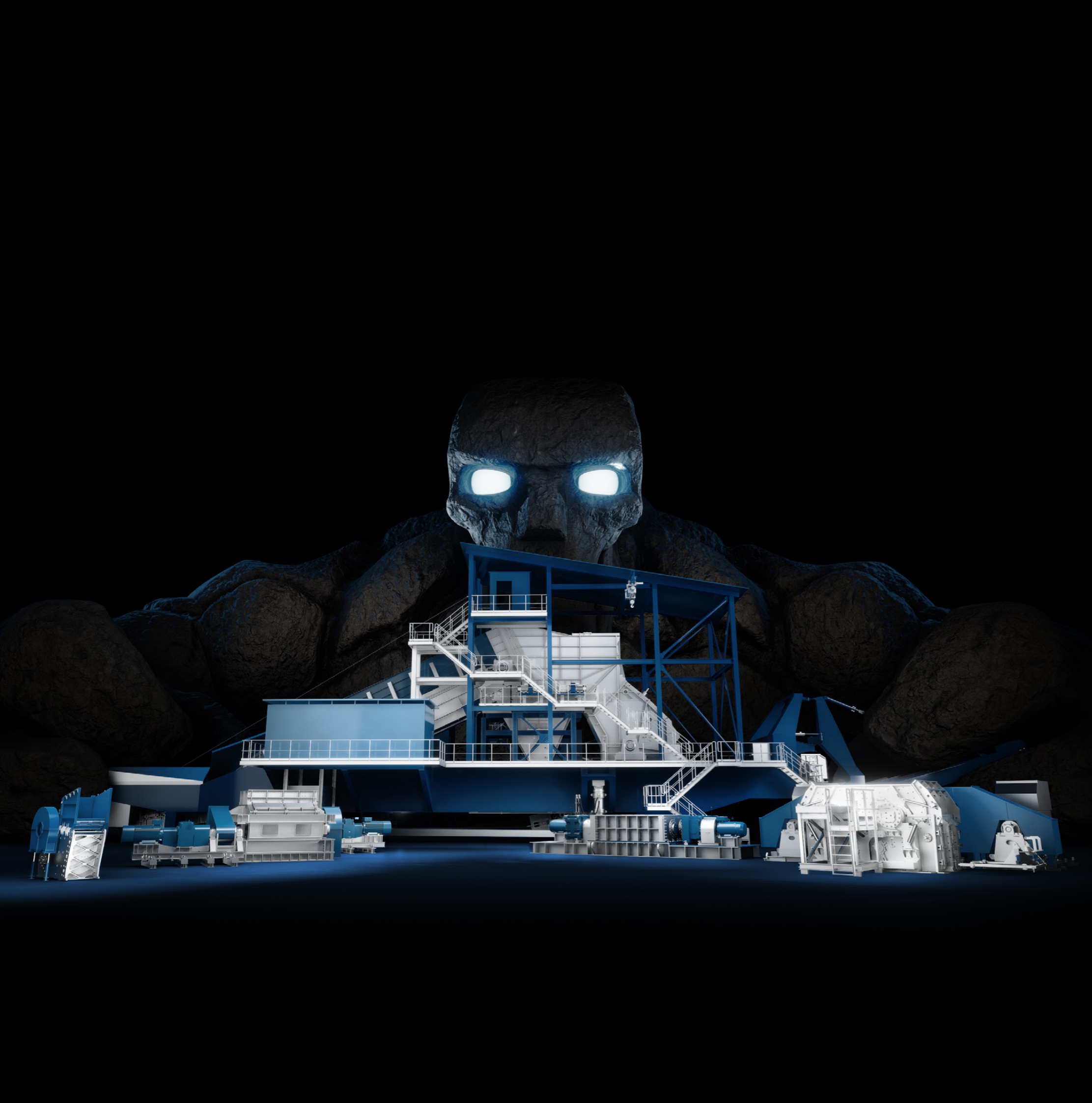

thyssenkrupp Polysius & crushing technologies

Discover the secret to achieving optimum performance and profitability for your plant with thyssenkrupp Polysius crushing technology. Our equipment is designed to ensure that you experience maximum benefits.

thyssenkrupp Polysius crushing technology offers a number of advantages to industrial operations. The technology is designed to improve product quality and increase the efficiency of production processes. It can also help to reduce energy consumption and maintenance costs while providing the perfect particle size distribution for the following individual process. Its robust design allows it to process large volumes with minimal downtime and provides reliable performance even in harsh conditions – making it an ideal choice for many industries operating in challenging conditions.



Mobile crushers

Unlock the full potential of your quarry operation with mobile crushers from thyssenkrupp Polysius.

Our state-of-the-art equipment offers superior performance, efficiency and flexibility, enabling you to achieve maximum productivity and profitability.

See the difference by upgrading your crushing operations with mobile crushers from thyssenkrupp Polysius.

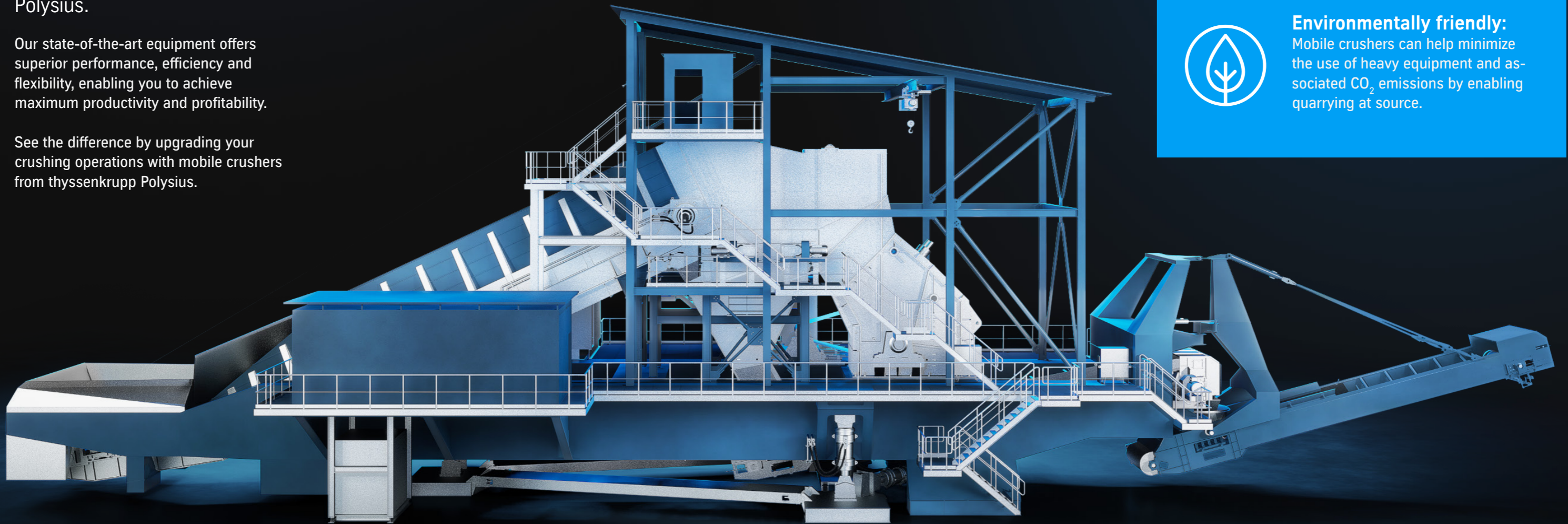

Mobility and flexibility:

Mobile crushing technology from thyssenkrupp Polysius makes it possible to closely follow the quarry face and optimize the quarry operations.



Cost savings:

The use of mobile crushers can reduce dismantling and logistics costs, as less time and resources are required to crush and transport the raw material.



Environmentally friendly:

Mobile crushers can help minimize the use of heavy equipment and associated CO₂ emissions by enabling quarrying at source.

Semi-mobile crushers

Increase the efficiency of your quarrying operations with semi-mobile crushers from thyssenkrupp Polysius.

These robust and reliable plants offer you the flexibility of a mobile solution with the stability of a stationary plant. Benefit from more efficient utilization, reduced costs and an environmentally friendly quarrying method. Discover the benefits of our semi-mobile crushers for your quarry projects now.

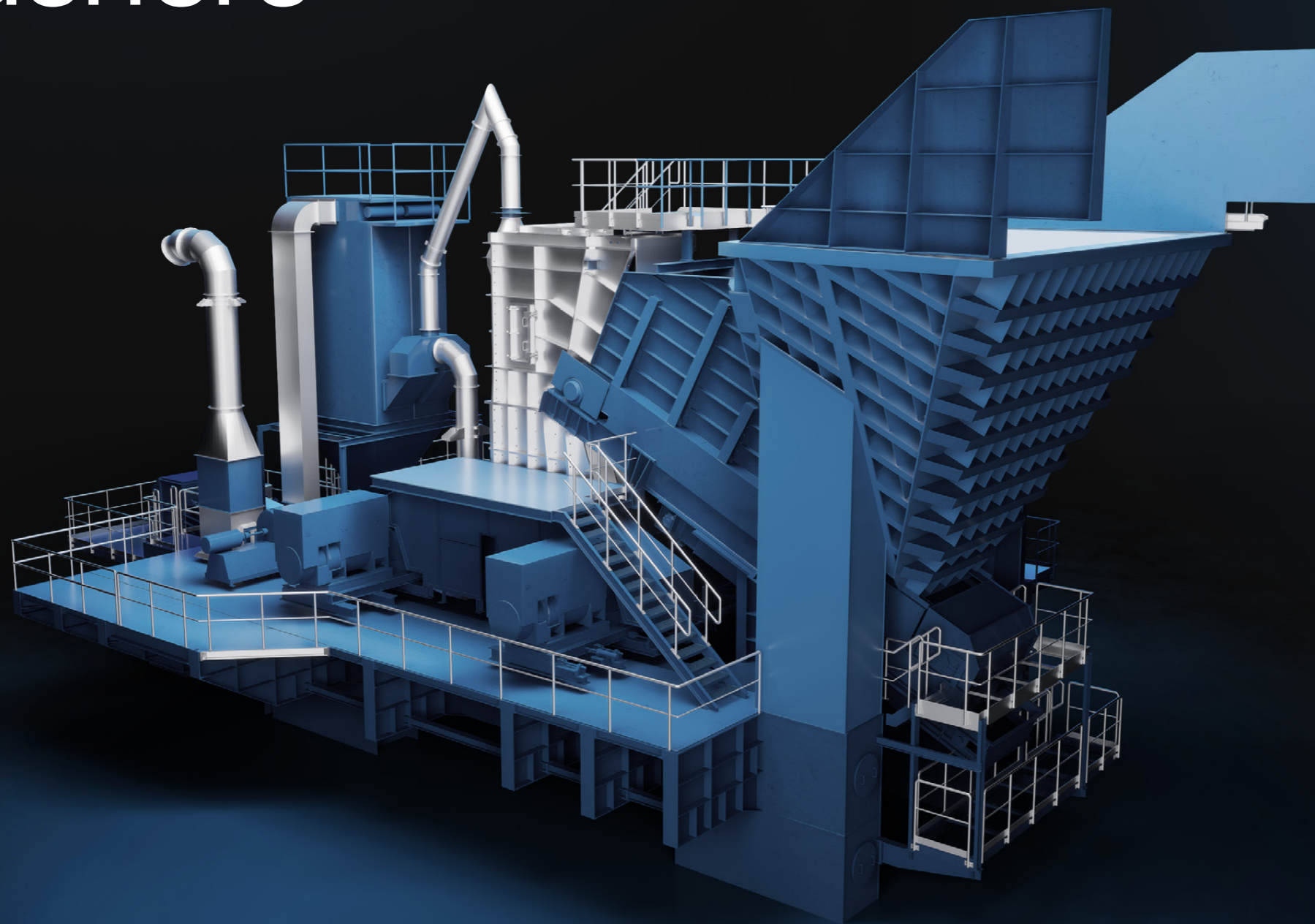

Flexibility:

Semi-mobile crushers from thyssenkrupp Polysius offer a high degree of flexibility as they can be transported to any desired location. This allows companies to adapt to changing project requirements and maximize the efficiency of their plants.



Environmental friendliness:

Semi-mobile crushers help to reduce CO2 emissions. Quarrying at the source eliminates the majority of CO2 emissions, benefiting both the company and the environment.



Maximum utilisation:

The high flexibility of the semi-mobile crushers allows for maximum plant utilization. This means that the plants can always be used optimally, resulting in higher efficiency and better economic success.



Compact design:

The design on 1-2 modules allows the plant to be relocated in less than 1 week. Preparation of the new crusher location ensures the least possible loss of time in production.

Stationary crushers

Are you looking for a reliable stationary crusher to improve your production process? Then thyssenkrupp Polysius is the right choice for you!

Their stationary crushers offer maximum operational reliability and safety, making them the ideal option for any business.

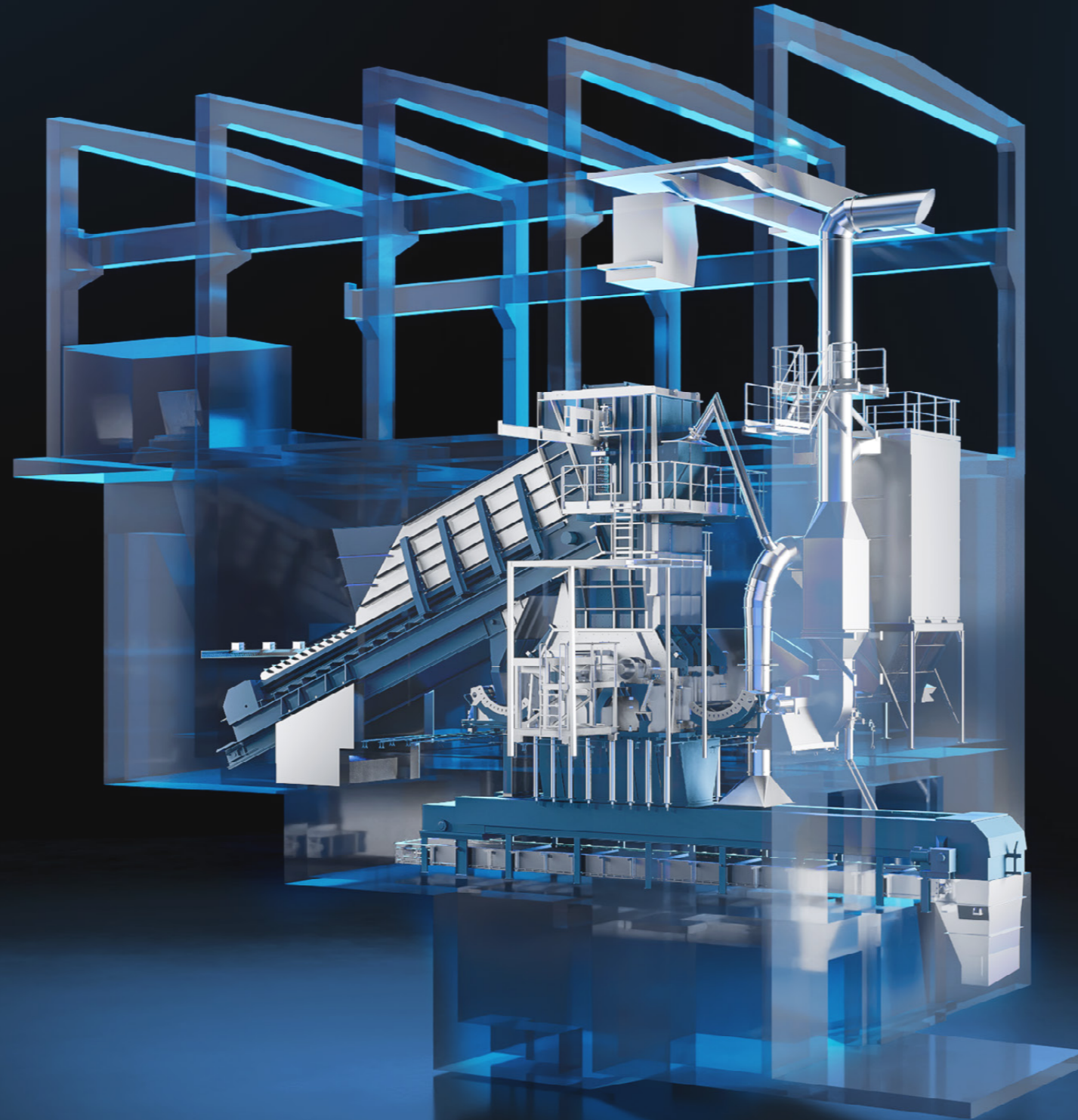

Cost-efficiency:

Stationary crushing installations from thyssenkrupp Polysius offer a cost-effective solution because of their compact and also maintenance friendly design.



Ease of maintenance:

thyssenkrupp Polysius stationary impact crushers are easy to maintain and repair. This minimizes downtime and increases plant availability, leading to greater efficiency and economic success.



Increased capacity:

With the powerful and reliable stationary impact crushers from thyssenkrupp Polysius, production capacity can be increased. This enables companies to produce more in less time and achieve higher sales.



Increased efficiency:

The high performance and reliability of thyssenkrupp Polysius stationary impact crushing installations can increase the efficiency of the entire production chain. This means that companies can produce more without compromising the quality of the end product.

Our view of service



Services are crucial in keeping a cement plant running over decades. Fast and uncomplicated support, state-of-the-art solutions and a partner with the required expertise – that is what cement plant operators are looking for.

We at thyssenkrupp Polysius are not only able to provide state-of-the-art engineering services, we can also deliver service solutions along the entire life cycle of your cement plant - from inspection and maintenance to supplying innovative OEM spare parts - all to enhance your competitiveness. You can always count on our highly qualified service staff to provide the best solutions – hand in hand with you, our customers. And with our global network and our new digital service solutions, we are always at your side - no matter when or where.

Our field & workshop services for your plants

We are your local service partner with plant know-how: With our local service centers, we have established a close-knit global network that is constantly developing. Therefore, we can provide fast, local and comprehensive assistance when it comes to supplying or overhauling strategic spare and wear parts. We also offer field service support, such as ad-hoc repairs, technical assistance, maintenance, inspections and additional services.



Spare parts management



Field and workshop services



Revamps and outages



Asset management